

# Refrigeration: Bottom Mount Freezer Slide

## Market Need:

- A sliding system that delivers superior sensorial performance, effective door closure and years of trouble free service.

## Design Challenges:

- Provide leading-edge self-close technology
- Deliver low effort force to open/close drawers
- Secure closure of doors
- Full access to drawer contents
- Simple hardware attachment methods
- Support heavy weight loads
- Achieve durability performance @300,000 cycles
- Eliminate rust, corrosion due to temperature and humidity



## KV Solution:

Features incorporated into bottom mount freezer slides include:

- Patented self-close mechanism with spring technology
- Appliance plating to provide corrosion resistance
- Precision roll forming & ball bearing technology
- Engineered food grade grease
- Full access to drawer content with full to over-travel slide design
- Belt-loops & bayonets for quick, secure installation
- RoHS Compliant

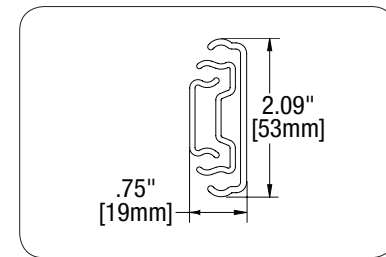

- 53mm (2.09") tall
- 19mm (.75") wide
- 3 member partial to over-travel extension

[Download Profile](#)

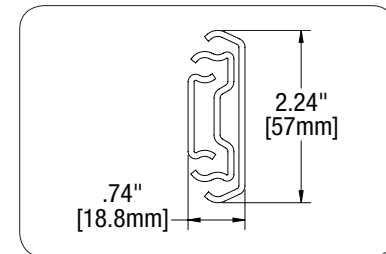

- 57mm (2.24") tall
- 18.8mm (.74") wide
- 3 member partial to over-travel extension

[Download Profile](#)



KNAPE & VOGT®